



Leaders in Fluid Handling Solutions

CALL US AT: 616-457-8782

www.strickequipment.com

J 1

LOADING ARMS, ACCESSORIES & REPAIR KITS

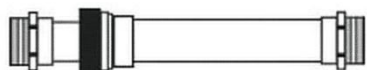
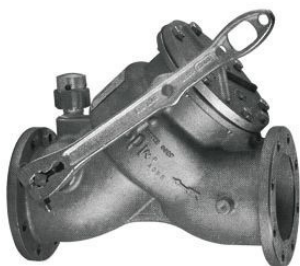







Strick Equipment is a Distributor for OPW Loading Arms, Accessories and Repair Kits. Please call the office at 1-877-737-4690 for assistance in ordering any of these items for your Bulk Plant application.

RHINO TUFF TANKS



Rhino Tuff Tanks are available in several sizes of Gravity Feed or Pump systems. Please call the office at 1-877-737-4690, and we will email you a mini catalog with descriptions and prices.

SWIVEL JOINTS

		MODEL #	PREFERRED	
<div><div><p>OPW Swivel Joints All Shown as 3600 series Cast Aluminum, except Styles 10 and 80 Female NPT both ends</p><div></div><p>Style 10 3 Planes of Rotation (not Available in Aluminum)</p><div></div><p>Style 30,34,35 1 Plane of Rotation</p><div></div><p>Style 50,56,58 2 Planes of Rotation</p><div></div><p>Style 70,76,78 2 Planes of Rotation</p><p>All swivels shown above are the 3600 aluminum series. Repair kits are available for all OPW swivels. Contact us for pricing</p><p>OPW Engineered Systems fabricated and cast ball bearing swivel joints offer many outstanding features that contribute to their dependability and long life. Quality construction standards include precision machining and 100% penetration welding by certified welders. OPW swivel joints allow you to construct a metal piping system that is moveable, flexible and reliable.</p><p>Also available in stainless steel, carbon steel, cast bronze and ductile iron. Call for details!</p></div><div><p>Style 20 1 Plane of Rotation</p><div></div><p>Style 40,44,45 1 Plane of Rotation</p><div></div><p>Style 60 2 Planes of Rotation</p><div></div><p>Style 80 3 Planes of Rotation (not Available in Aluminum)</p></div></div>		Style 20	1 1/2" 27-3620-0151	\$ 286.34
			2" 27-3620-0201	\$ 416.26
			3" 27-3620-0301	\$ 527.96
			4" 27-3620-0401	\$ 655.89
		Style 30	1 1/2" 27-3630-0151	\$ 329.38
			2" 27-3630-0201	\$ 449.26
			3" 27-3630-0301	\$ 572.83
			4" 27-3630-0401	\$ 685.46
		Style 40	1 1/2" 27-3640-0151	\$ 397.16
			2" 27-3640-0201	\$ 421.30
			3" 27-3640-0301	\$ 665.44
			4" 27-3640-0401	\$ 836.82
		Style 50	1 1/2" 27-3650-0151	\$ 599.56
			2" 27-3650-0201	\$ 742.34
			3" 27-3650-0301	\$ 945.17
			4" 27-3650-0401	\$ 1,381.48
		Style 60	1 1/2" 27-3660-0151	\$ 534.65
			2" 27-3660-0201	\$ 763.78
			3" 27-3660-0301	\$ 901.26
			4" 27-3660-0401	\$ 1,227.77
		Style 70	1 1/2" 27-3670-0151	\$ 667.14
			2" 27-3670-0201	\$ 771.26
			3" 27-3670-0301	\$ 1,031.09
			4" 27-3670-0401	\$ 1,525.64

DECKO PUMPS AND IMPELLERS

Decko Pump



This is the original Simer impeller pump used for years in the petroleum industry to transfer fuel or water from small tanks and sumps. It can be easily mounted on a channel iron or wooden base using a 2 piece coupling and a foot mounted motor. The pump is available in 3/4" (BP20X) or 1" (BP21X) with the X signifying an impeller suitable for fuel.

MODEL

PREFERRED

52-BP20X

3/4"

Up to 15 GPM

\$ 231.21

52-BP21X

1"

Up to 28 GPM

\$ 300.68

Decko Impeller Kits

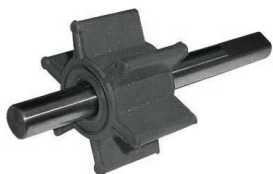

Kit includes impeller, shaft and body gasket.
52-53X fits BP20X, 52-63X fits BP21X

52-53X

\$ 51.87

52-63X

\$ 63.95

Decko "The Bull Dog"



52-90000

Non-explosion
Proof

\$ 1,002.19

52-91000

Explosion
Proof

\$ 1,709.60

The Bull Dog incorporates a Simer impeller pump with 1/2 HP GE commercial grade motor, 8' grounded power cord, base, coupling and guard for a system that is easy to carry and quick to set up. Just add quick couplers and 1" suction and discharge hoses. The Bull Dog is capable of up to 28 GPM and can handle most corrosive and flammable liquids, as well as water up to 180*



Leaders in Fluid Handling Solutions
CALL US AT: 616-457-8782
www.strickequipment.com

J 4

NOTES

**PLEASE USE THIS PAGE TO KEEP TRACK OF YOUR MOST
POPULAR ITEMS ORDERED AND THEIR PART NUMBERS**



Leaders in Fluid Handling Solutions

CALL US AT: 616-457-8782

www.strickequipment.com

J 5

NOTES

**PLEASE USE THIS PAGE TO KEEP TRACK OF YOUR MOST
POPULAR ITEMS ORDERED AND THEIR PART NUMBERS**



Leaders in Fluid Handling Solutions
CALL US AT: 616-457-8782
www.strickequipment.com

J 6

NOTES

**PLEASE USE THIS PAGE TO KEEP TRACK OF YOUR MOST
POPULAR ITEMS ORDERED AND THEIR PART NUMBERS**